

# LINEAR SYSTEM CABLE TRAY

— Thomas Bentzen

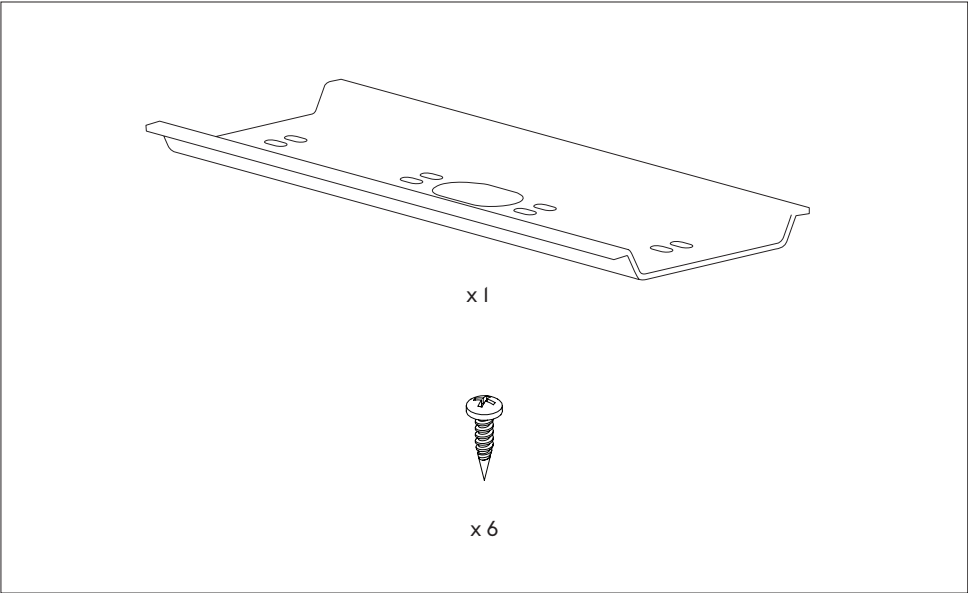

240 CM (TABLE, MIDDLE MODULE, END MODULE):  
1-3 Cable Trays

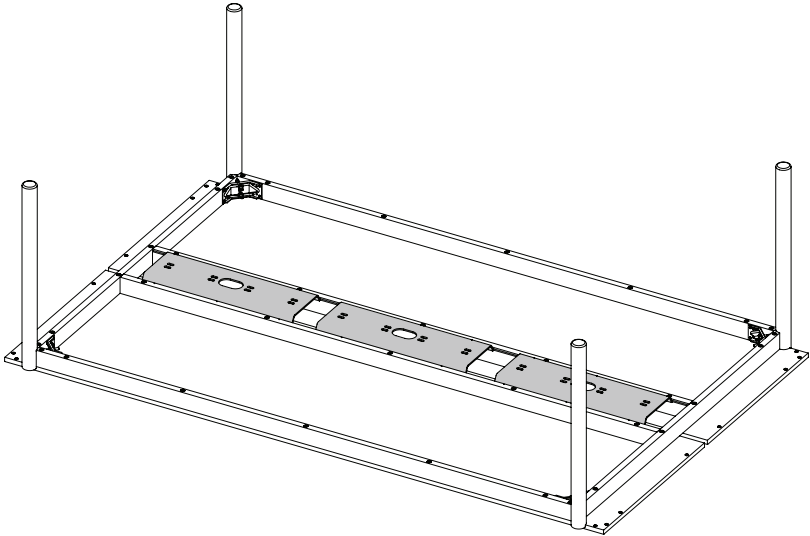

120 CM (END MODULE):  
1 Cable Tray

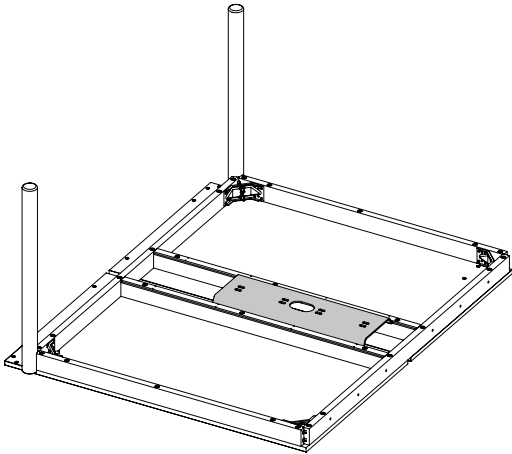

1

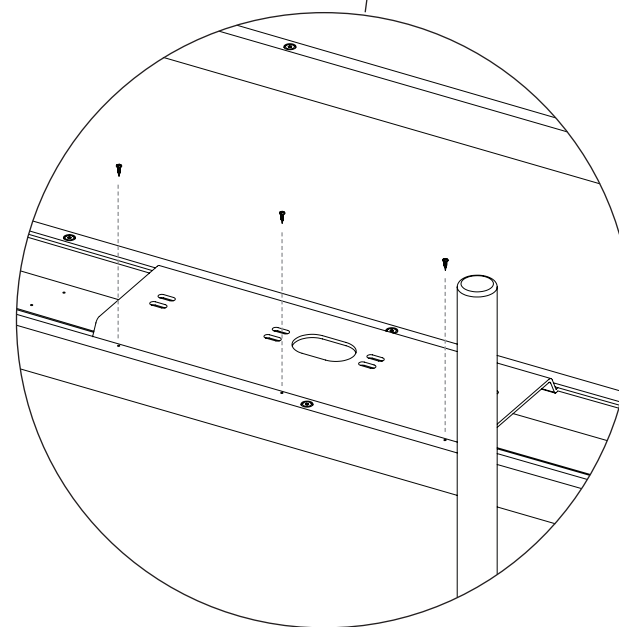
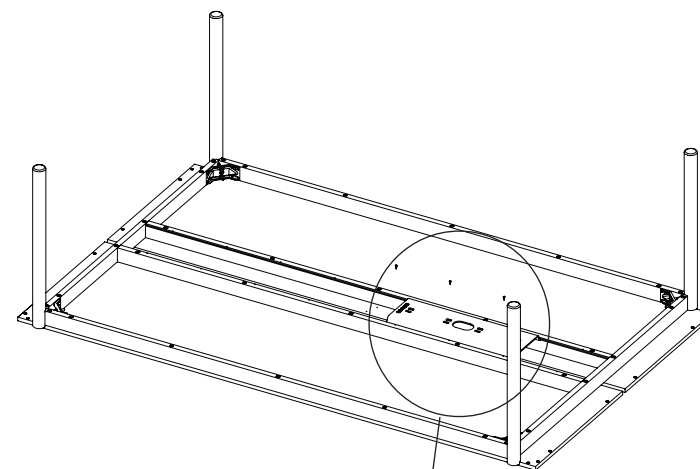
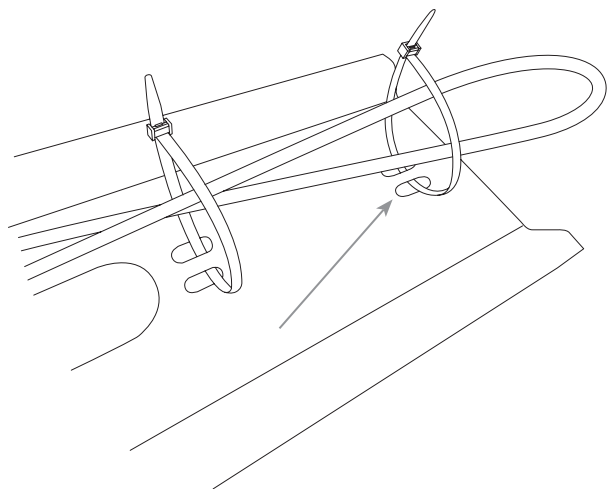
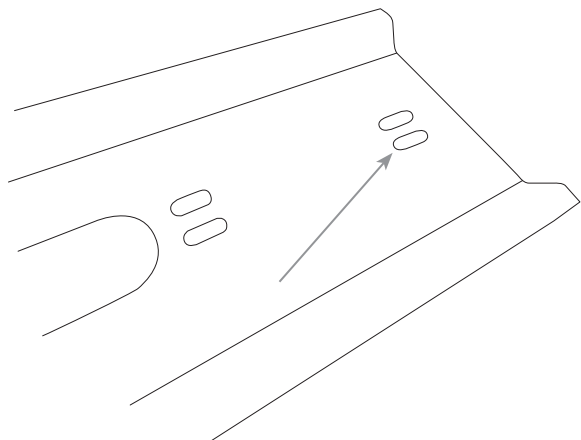

2 Close Cable Tray WITHOUT additional screws:

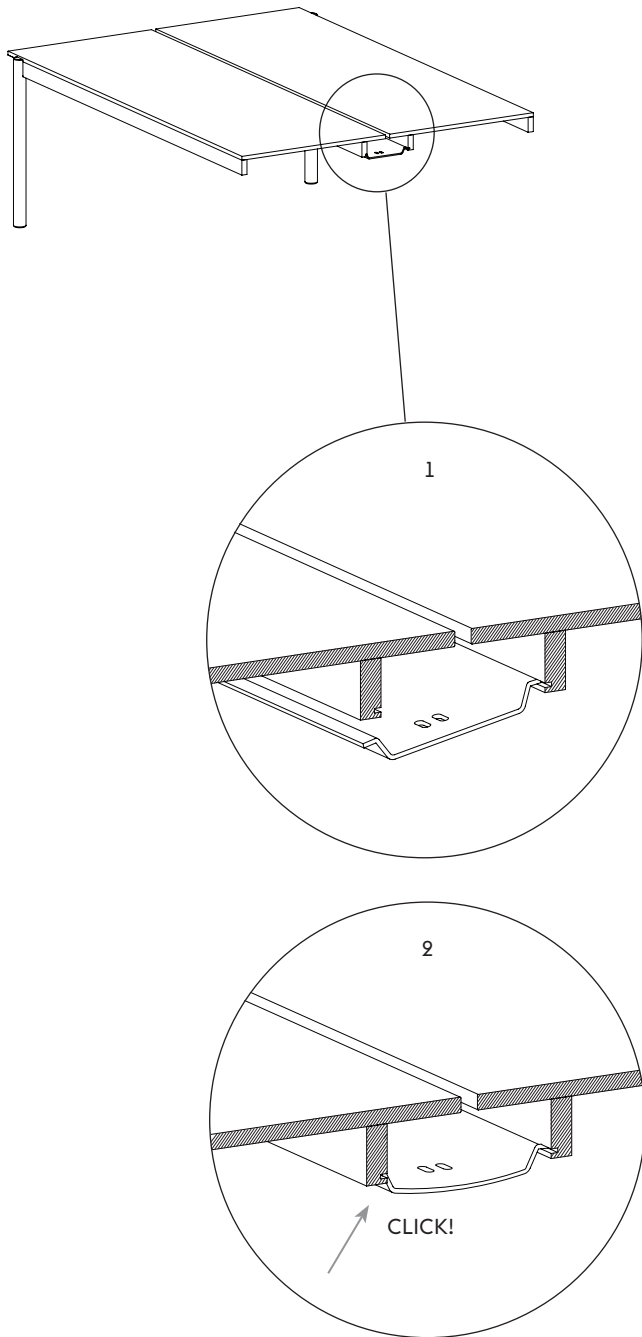

3 ... or, close Cable Tray WITH additional screws for a hinged solution

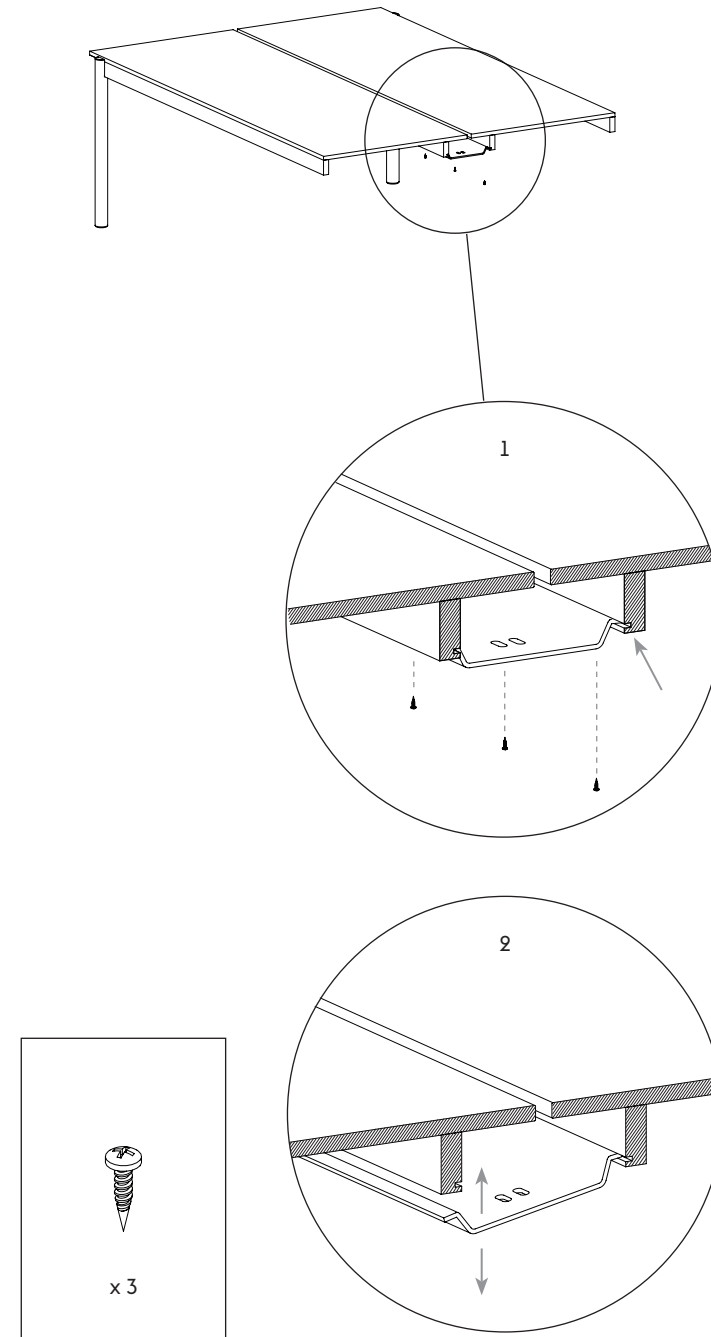

## CLEANING — RENGØRING — REINIGUNG — NETTOYAGE — LIMPIEZA

- EN Vacuum to remove dust. Clean off any marks with a clean, moist cloth.
- DK Fjern støv med en støvsuger. Rengør snavs med en ren, fugtig klud.
- DE Zum Staubentfernen Staubsauger verwenden. Jegliche Verschmutzung mit sauberem, feuchtem Tuch reinigen.
- FR Passer l'aspirateur pour retirer la poussière. Propre et exempte de toute marque avec un linge humide.
- ES Utilize el aspirador para quitar el polvo. Limpie cualquier marca con un paño húmedo.